

C E S A R

TANGRAM

Design by Garcia Cumini

Thinking outside of the box and sparking curiosity are the concepts which guided Garcia Cumini and Cesar in the creation of Tangram. Inspired by the ancient Chinese game of geometric shapes that can be combined with on another to create endless figures, Cesar's product echoes modular logic while avoiding linearity. The Tangram project exalts the curve and its infinite possible combinations.



cesar.it

©Cesar Arredamenti Spa

C E S A R

TANGRAM

Design by Garcia Cumini

THE PROTAGONISTS OF THE TANGRAM PROJECT

Tangram is made up of five curved elements that can be added to Cesar's modules at will to build kitchen islands with unusual shapes, compositions set against the wall, or even solutions that wrap around corners. These eccentric shapes aren't made up of simple semicircles or portions of circles, but rather follow a fixed radius that is different for every module, introducing a new concept of sinuosity in kitchen design and adapting to various needs.

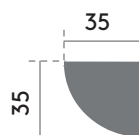

H84/138

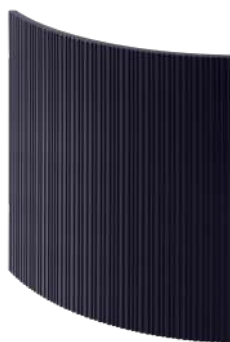
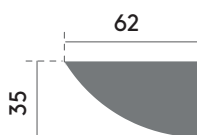

H84

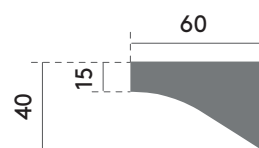

H84

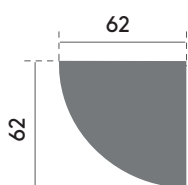

H84

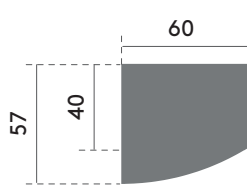

H84

C E S A R

TANGRAM

Design by Garcia Cumini

PUT TOGETHER YOUR TANGRAM

Island

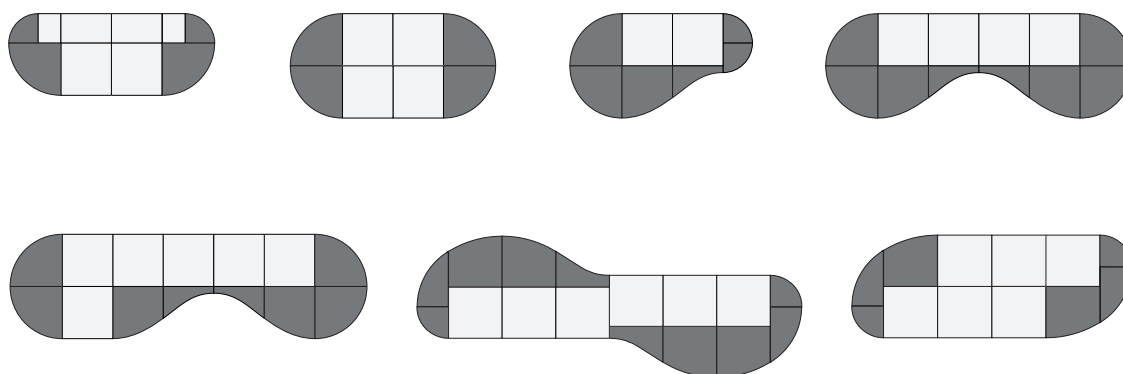

Peninsula

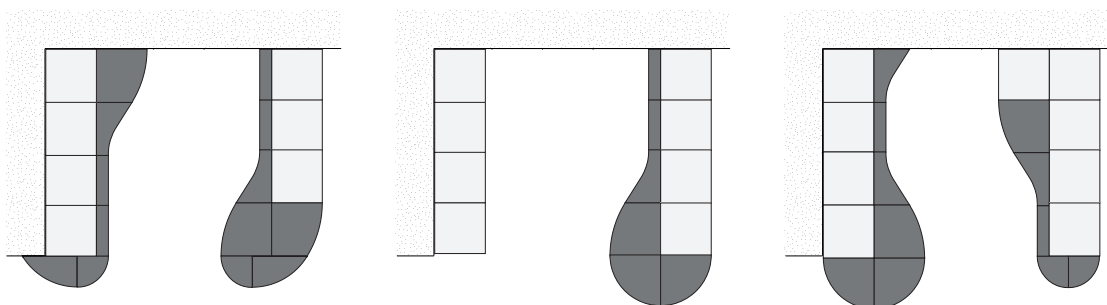

Back-to-wall

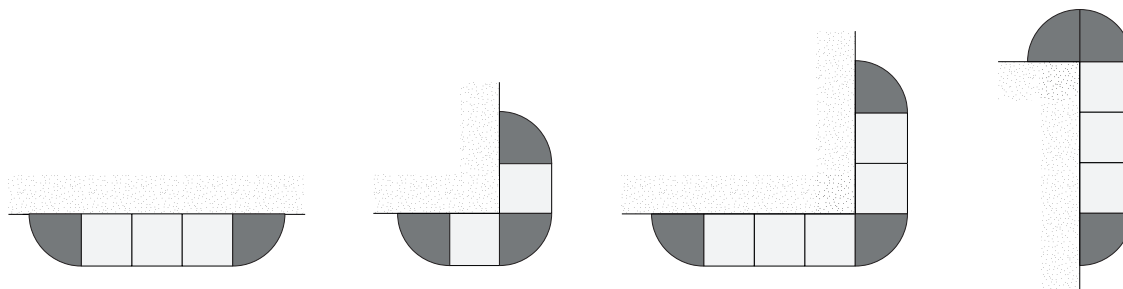

TANGRAM

Design by Garcia Cumini

GENERAL FEATURES TANGRAM CURVE CARCASS

Carcasses: The materials used are FSC/Carb Phase II /TSCA Title VI compliant/F**** and V100 certified and ensure very low formaldehyde emissions and maximum resistance to humidity. They are 18 mm thick to ensure the perfect stability and durability of the hardware used.

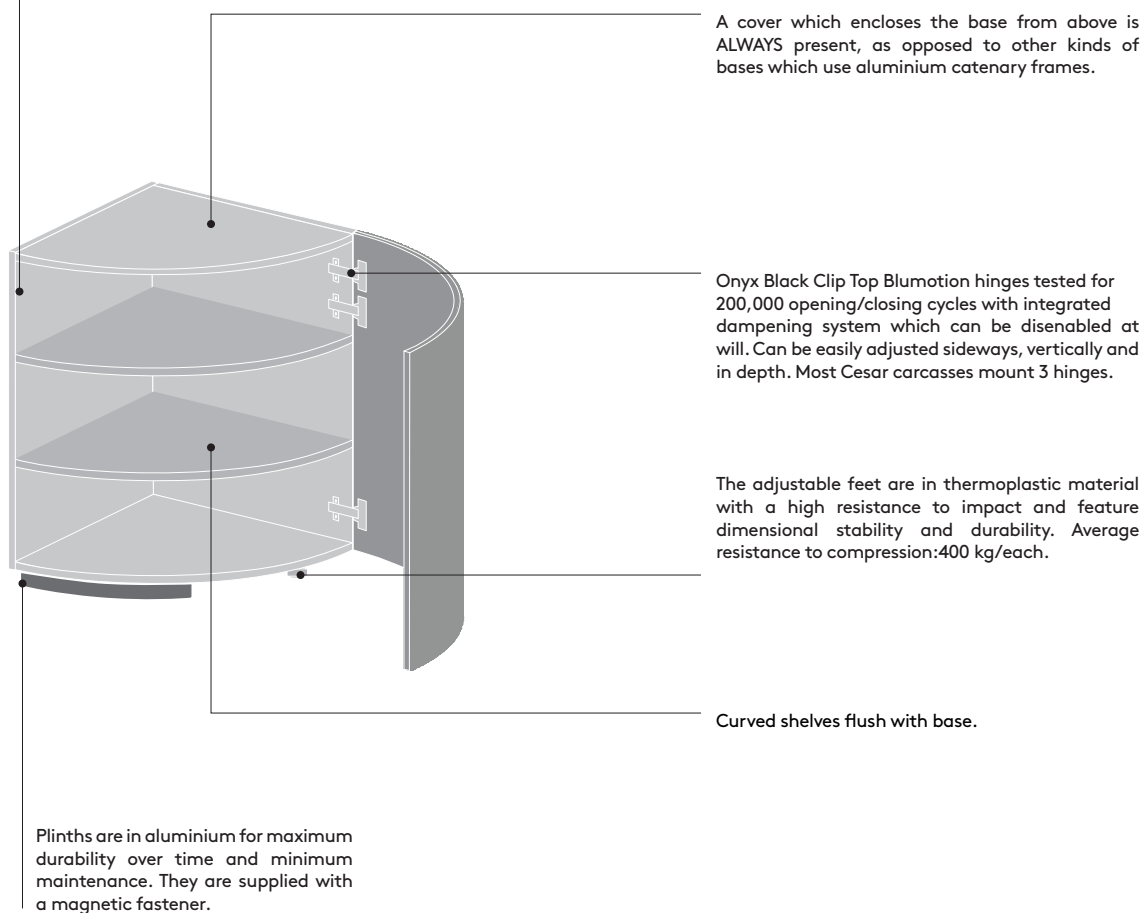

A cover which encloses the base from above is ALWAYS present, as opposed to other kinds of bases which use aluminium catenary frames.

Onyx Black Clip Top Blumotion hinges tested for 200,000 opening/closing cycles with integrated dampening system which can be disenabled at will. Can be easily adjusted sideways, vertically and in depth. Most Cesar carcasses mount 3 hinges.

The adjustable feet are in thermoplastic material with a high resistance to impact and feature dimensional stability and durability. Average resistance to compression:400 kg/each.

Curved shelves flush with base.

Plinths are in aluminium for maximum durability over time and minimum maintenance. They are supplied with a magnetic fastener.

TANGRAM

Design by Garcia Cumini

INFORMAZIONI GENERALI ANTE TANGRAM



WITH GROOVE DOOR

The Groove door, with a thickness of 2.2, is made up of a sequence of vertical grooves which create an irregular three-dimensional pattern, designed to hide the joint between the modules and ensure a unitary perception of the entire arrangement.



WITH PLEIN DOOR

2.2 cm thick door suitable for the push-to-open and Cesar's collection edgings.

FOCUS ON GROOVE DOOR

To accentuate Tangram's fluidity, the cabinet door features a special decorative detail made up of a sequence of vertical grooves designed and created with specific spacing for every single curved and linear model in the Tangram family, with the objective of creating an irregular three-dimensional pattern designed to hide the joints between modules and ensure a unitary perception of the entire arrangement. The irregular contour, the alternation between full and empty space, and the play of light and shadows conceal the openings of the doors, thus contributing to the final camouflaged effect. This design guarantees the alignment of the grooves' spacing in the moment that the doors are being installed next to one another.

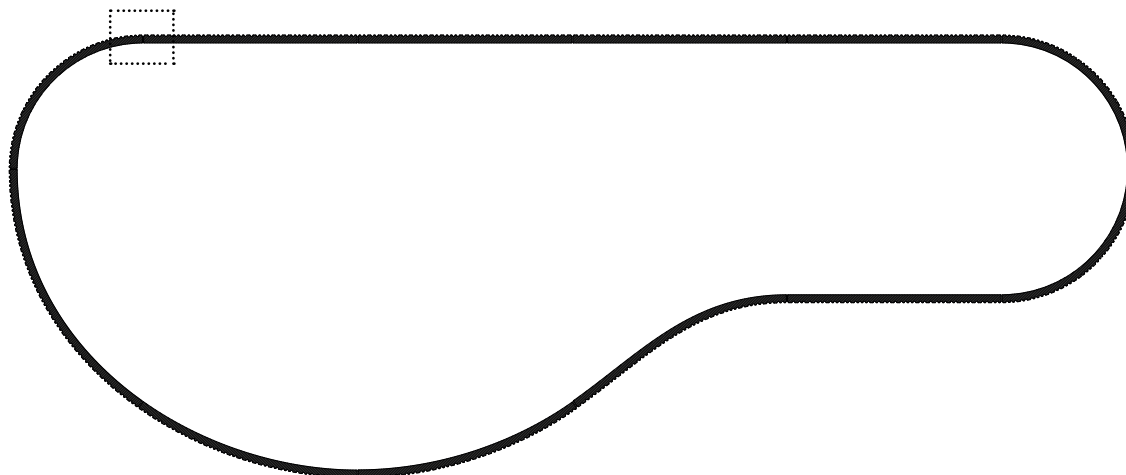

TANGRAM

Design by Garcia Cumini

DOORS

Door edge
thickness 22 mm

Plein door

Groove door

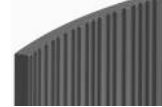

Opening methods

push pull

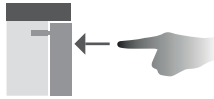

door with handle



BASE UNIT H84 PLINTH H6

Straight base

drawers and jumbo
drawers

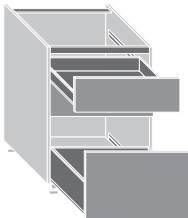

Cenere

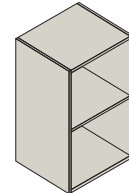

hinged door

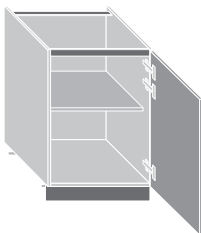

Grigio Fumo

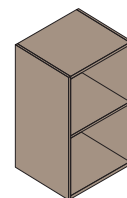

Curved base

hinged door only

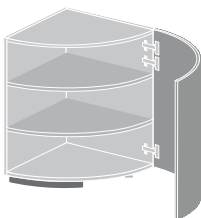

Rovere Bruno



C E S A R

TANGRAM

Design by Garcia Cumini

HANDLES RECOMMENDED BY CESAR

To enhance every detail of the project, the new Oi and Accento handles are now available, designed to fit into the doors' three-dimensional groove.

NEW - ACCENTO



Champagne



Nickel



Polished black nickel



Black



Bronze

NEW - OI (H12 e H23)



Champagne



Nickel



Polished black nickel



Black



Bronze

TRATTO



Brushed Champagne



Brushed Black



Brushed Aluminium

FILO 25



Matt aluminium



Black aluminium



White Aluminium









TANGRAM

Design by Garcia Cumini

AVAILABLE FINISHES

	Plein door	Groove door
LACQUERS		
Gloss	✗	✗
Silk-effect	✓	✓
STRUCTURED LACQUERS	✓	✓
METALLIC EFFECT LACQUERS		
Oxidized effect	✓	✗
Satin effect	✗	✗
Anodyc effect	✓	✓
WOOD VENEERS		
Oaks	✓	✓
ELMS	✓	✓

NEW 2022 LACQUERED COLORS

	Plein door	Groove door
<div style="display: flex; justify-content: space-between;"> <div style="text-align: center;">  <p>LS26 Verde Comodoro</p> </div> <div style="text-align: center;">  <p>LS27 Verde Brac</p> </div> <div style="text-align: center;">  <p>LS28 Blu Fes</p> </div> <div style="text-align: center;">  <p>LS20 Rosso Jaipur</p> </div> </div>	✓	✓
<div style="display: flex; justify-content: space-between;"> <div style="text-align: center;">  <p>LS26 Verde Comodoro</p> </div> <div style="text-align: center;">  <p>LS27 Verde Brac</p> </div> <div style="text-align: center;">  <p>LS28 Blu Fes</p> </div> <div style="text-align: center;">  <p>LS20 Rosso Jaipur</p> </div> </div>		

TANGRAM

Design by Garcia Cumini

WORKTOPS

Natural stone	✓
Engineered stone	✓
MDi Inalco	✓
Dekton ceramics	✓
HPL bordo ABS	Being Assessed
Technomat with ABS edging	Being Assessed
Layered Unicolor	Being Assessed
Layered Fenix	Being Assessed
Glasses	✗
Inox	✗

The worktop could have one or more joints depending on the size of the composition and the chosen materials.

MACARON for Natural stone and Engineered stone

The Tangram collection's look of seamless sinuosity is also created by the new Macaron detail present along the edge of the 22 cm thick natural stone and marble aggregate worktop, which recalls a traditional drip-saving groove and makes the rounded edge (created by hand using ancient techniques) both functional and aesthetically pleasing.



Macaron Éclair
edge processing



Macaron
edge processing

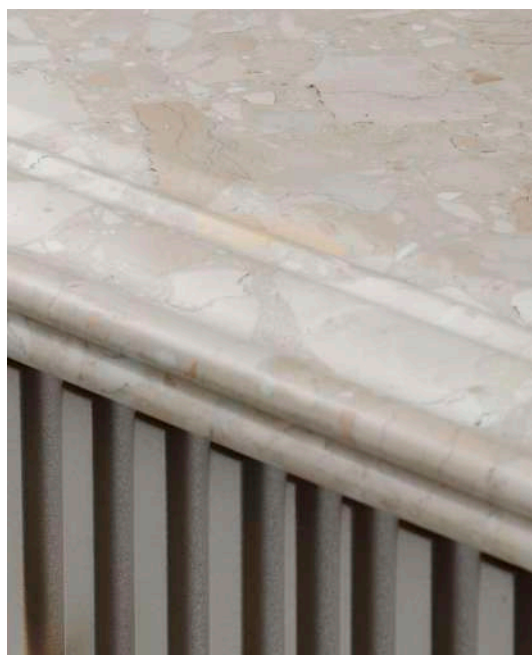

C E S A R

TANGRAM



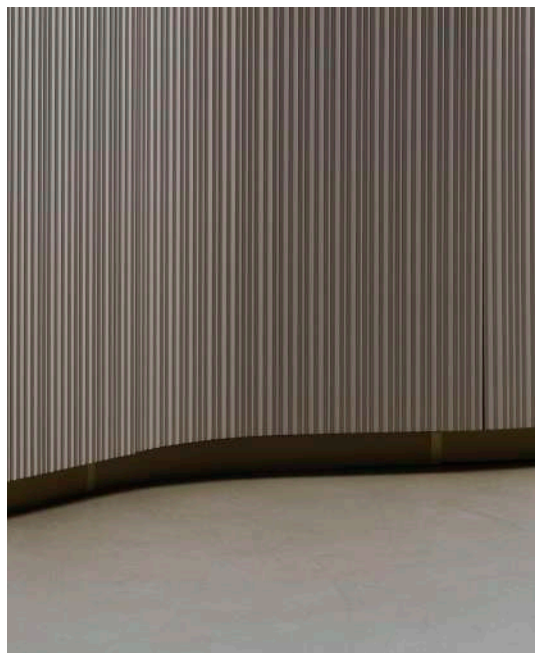



Design by Garcia Cumini



PLINTH

The curved plinths are positioned next to one another and covered by caps. The joints between them correspond with the bases and their curved doors.

FINISHES

Matt aluminium	
Black aluminium	
Champagne aluminium	
Bronze aluminium	
White painted aluminium	
Gloss and Silk-effect lacquers	

TANGRAM

Design by Garcia Cumini

CONSTRAINTS FOR POSITIONING APPLIANCES

Sinks and cook tops cannot be positioned on curved bases.

WRONG POSITIONING

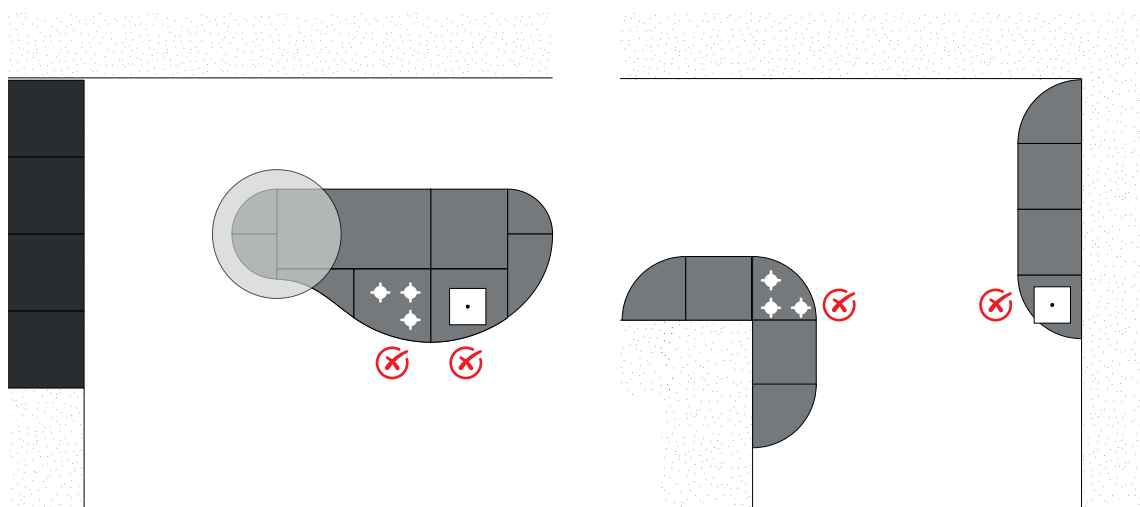

CORRECT POSITIONING

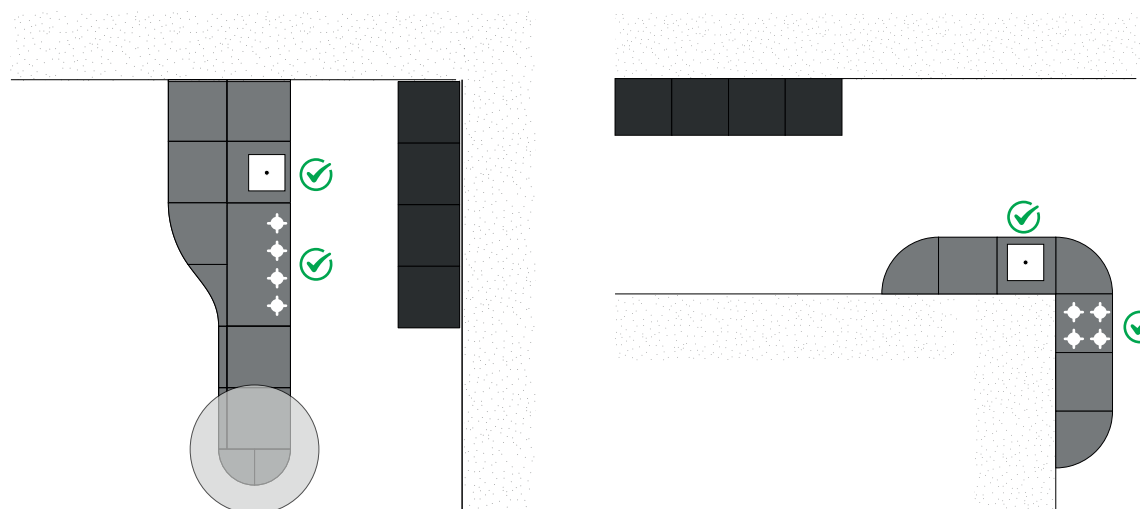

CUPBOARD TANGRAM

Design by Garcia Cumini

Tangram, with a height of 138 cm, makes it possible to have elegant cabinets that interact with the kitchen, living room, and bathroom environments, giving them a delicately modern and entirely original look.



WITH GROOVE DOOR

The Groove door, with a thickness of 2.2, is made up of a sequence of vertical grooves which create an irregular three-dimensional pattern, designed to hide the joint between the modules and ensure a unitary perception of the entire arrangement.



WITH PLEIN DOOR

2.2 cm thick door suitable for the push-to-open and Cesar's collection edgings.



WITH GLASS CABINET DOOR

Door in black anodized aluminum, 2.2 cm thick, with 0.4 cm thick tempered glass. The door can be enriched with the application of a fabric whose natural textures will give elegance and warmth to the environment.

external side

internal side



CUPBOARD TANGRAM

Design by Garcia Cumini

KITCHEN & LIVING

The Tangram cabinet, whether set against the wall or double-sided, can also be designed for the living room and dining room environments, making it possible to establish fluidity and continuity in the transition from one area of the house to another.

Example of wall composition

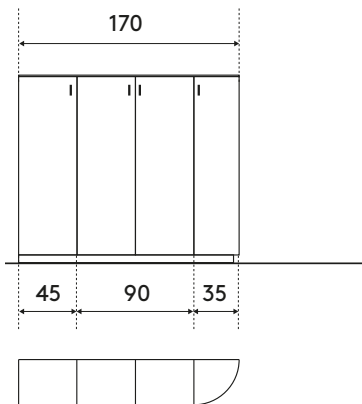

Example of double-sided composition

Living

Kitchen

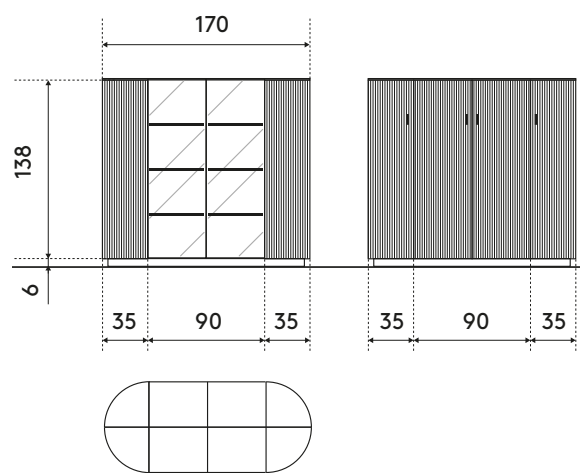
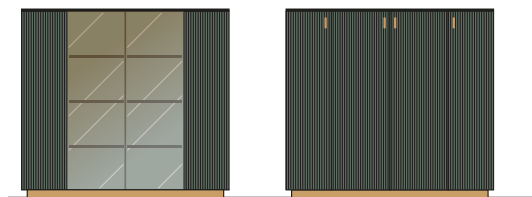

CUPBOARD TANGRAM

Design by Garcia Cumini

GENERAL CHARACTERISTICS TANGRAM CABINET WITH CURVED CARCASS

Carcasses: The materials used are FSC/Carb Phase II /TSCA Title VI compliant/F**** and V100 certified and ensure very low formaldehyde emissions and maximum resistance to humidity. They are 18 mm thick to ensure the perfect stability and durability of the hardware used.

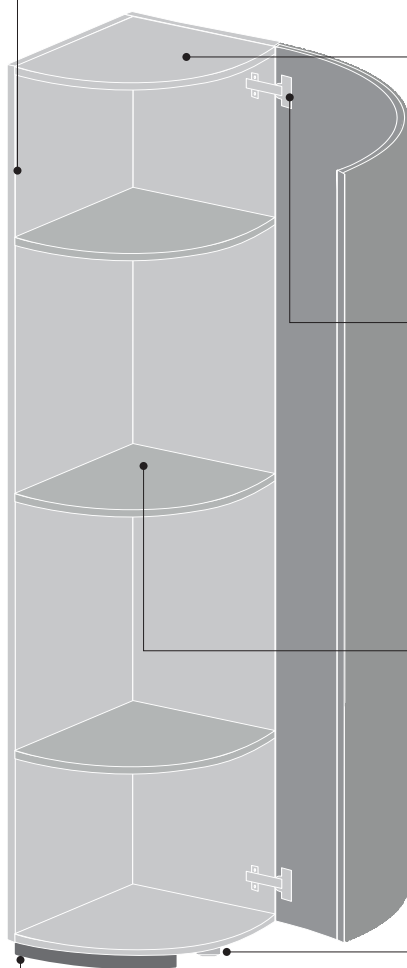

As with the H134 tall units, a cover which encloses the base from above is present, as opposed to other kinds of bases which use aluminium catenary frames.

Cesar cabinets have 2 hinges, which differ from the Clip Top Blumotion hinges due to their smaller size and the way they conceal all mechanical parts no matter the position of the door, whether closed, open, or moving.

Curved shelves flush with the base.

The adjustable feet are in thermoplastic material with a high resistance to impact and feature dimensional stability and durability. Average resistance to compression: 400 kg/each.

Plinths are in aluminium for maximum durability over time and minimum maintenance. They are supplied with a magnetic fastener. The junction between the bases falls in correspondence with the bases and is covered by caps.

CUPBOARD TANGRAM

Design by Garcia Cumini

GENERAL INFORMATION

Door thickness

22 mm

Door edge

Glass cabinet door*

Groove door

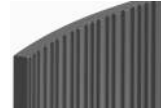

Opening methods

push pull

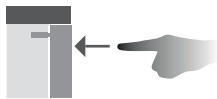

door with handle



door with handle integrated into the frame



* Glass door not available for curved modules

CUPBOARD TANGRAM

Design by Garcia Cumini

BASE UNIT H138 PLINTH H6

Straight base

hinged door
D35

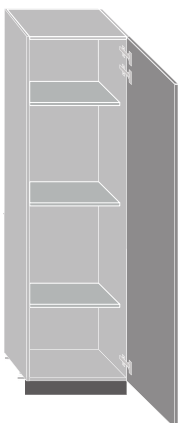

Cenere

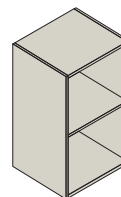

Grigio Fumo

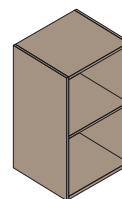

glass cabinet door
D35

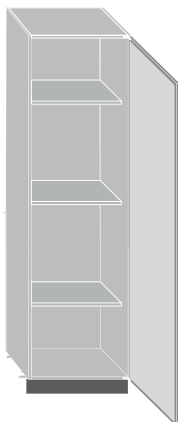

Rovere Bruno



Curved base

hinged door
D35

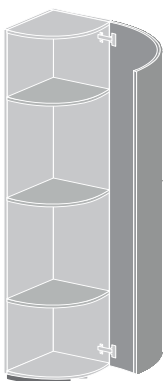

Silk-effect lacquers*

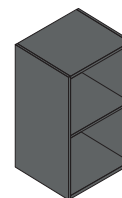

*customizable carcass with extra charge

CUPBOARD TANGRAM

Design by Garcia Cumini

HANDLES RECOMMENDED BY CESAR

NEW - ACCENTO



Champagne



Nickel



Polished black nickel



Black



Bronze

NEW - OI (H12 e H23)



Champagne



Nickel



Polished black nickel



Black



Bronze

CUPBOARD TANGRAM

Design by Garcia Cumini

INCORRECT CABINET COMPOSITION

In every composition it is necessary to have at least one 30 cm carcass with a straight door.



It is only possible to install hinged doors.



It is only possible to install hinged doors.

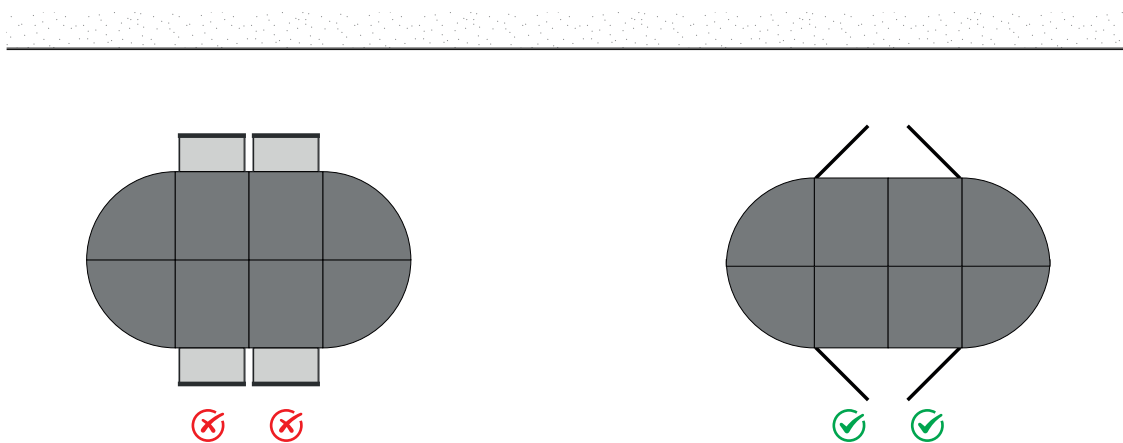

TANGRAM

Design by Garcia Cumini

FINISHES

Plein door	Groove door
✓	✓

SILK-EFFECT LACQUERES

Lacquer is a pigmented polyurethane resin applied to a MDF panel. Lacquering can have a silk-effect (matt) finish. To achieve the silk effect, a matting agent is applied directly over the lacquer.

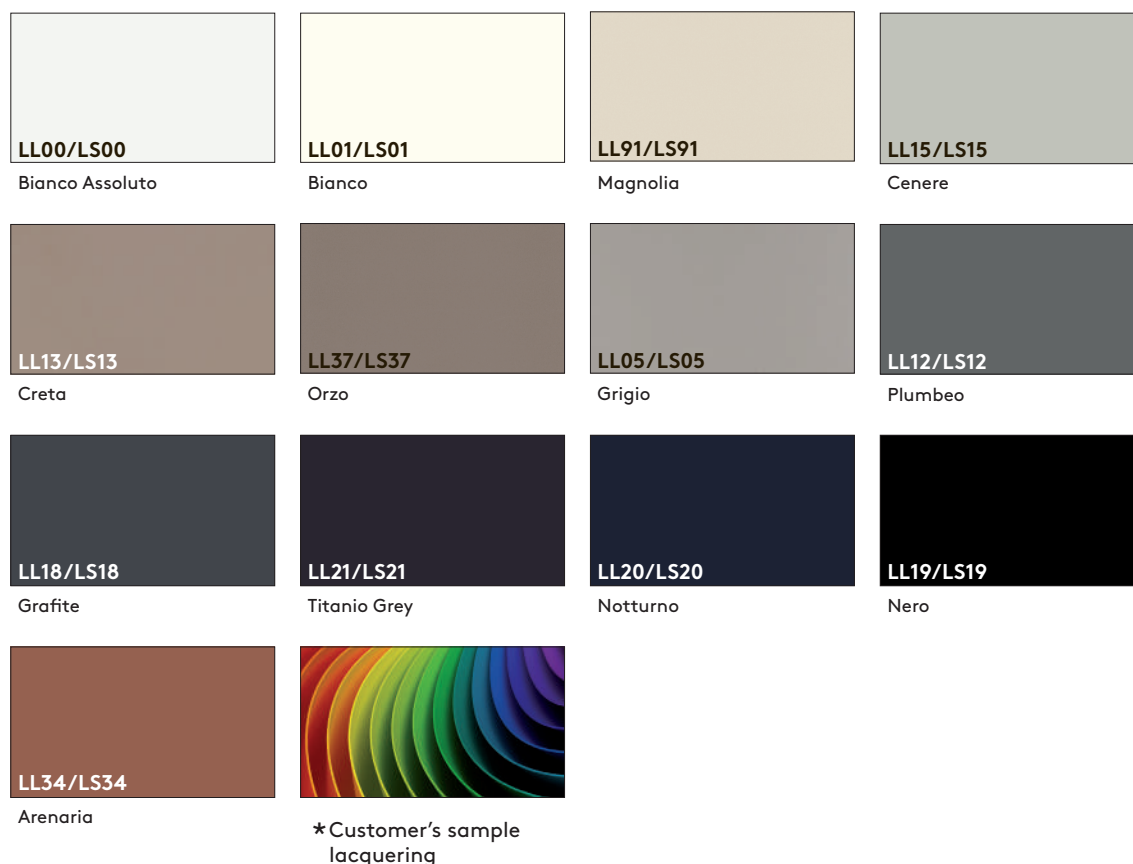

NEW COLORS 2022 SILK-EFFECT LACQUERES



TANGRAM

Design by Garcia Cumini

FINISHES

Plein door	Groove door
✓	✓

STRUCTURED LACQUERS

This is a soft and elegant interpretation of paint for exteriors. This coating takes on different nuances depending on the light, creating changing tones that make surfaces “vibrate”. A polyurethane basecoat is applied to an MDF panel. The edges are coated twice. After having sanded the panel, a coat of coloured lacquer is applied that basically creates a slight orange-peel effect and metallic reflections that give the door surface a “rippled” look. This finish features a textured surface and metallic pigments that enhance the colour with different hues depending on how light reflects on the surface. In pale-coloured finishes like quartz, this feature is more apparent and must be considered as a distinguishing feature of the finish and not as a fault.

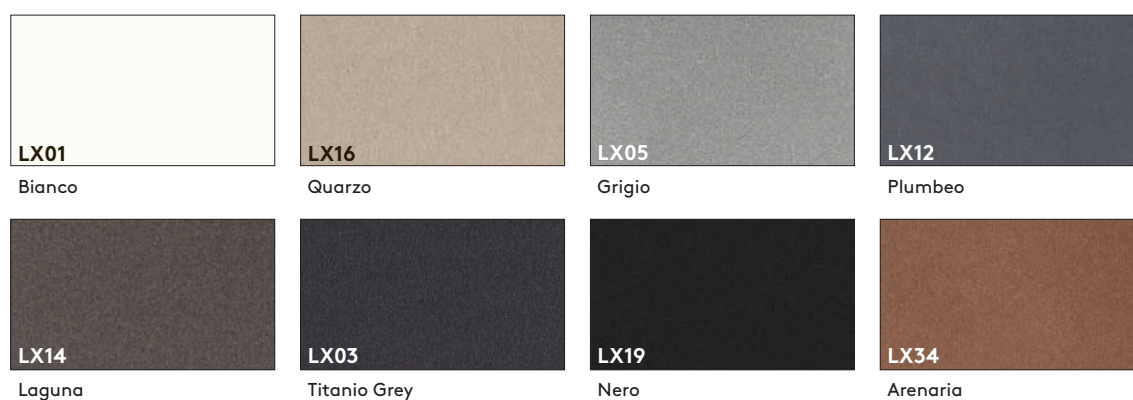

NEW 2022 COLOURS – STRUCTURED



TANGRAM

Design by Garcia Cumini

FINISHES

METALLIC EFFECT LACQUERS

These finishes reproduce the effect of metals. A dark basecoat is applied to an unfinished MDF panel after which the skilled hands of lacquerers apply the metallic lacquer so as to create subtle, soft, light and dark differences in shade that produce a sort of 3D effect.

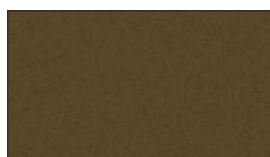

Ottone ossidato

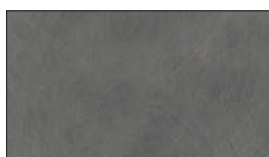

Acciaio ossidato

Plein door	Groove door
✓	✗

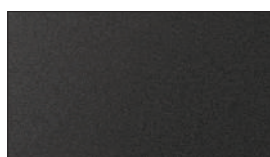

Ferro anodyc

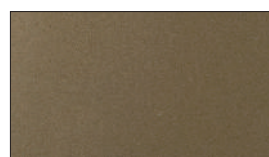

Ottone anodyc

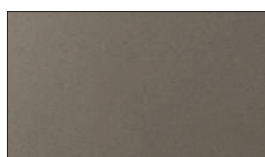

Nichel anodyc

Plein door	Groove door
✓	✓

NEW 2022 COLOURS - ANODISED



LE26

Verde Comodoro

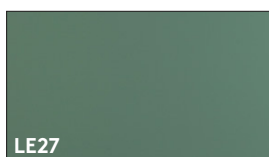

LE27

Verde Brac



LE28

Blu Fes

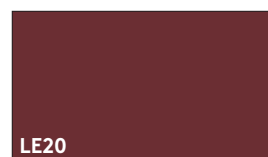

LE20

Rosso Jaipur

TANGRAM

Design by Garcia Cumini

FINISHES

Plein door	Groove door
✓	✓

WOOD VENEERS

A sheet of precious wood veneer is applied to a wood particleboard panel to give the finish a natural look and feel. This type of finish reduces the environmental impact created by felling trees because it replaces solid wood while preserving the same aesthetics. Moreover, it produces a lighter and more stable product. A finishing cycle of acrylic varnish preserves its features during day-to-day use.

OAK (ROVERE)

is derived from trees belonging to the fagaceae family and is available in a palette of light, medium and dark colours to create timeless settings. First finishes are not available with a continuous grain match.

(vertical grain)

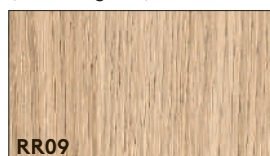

RR09

Rovere Nordico



RR10

Rovere Mediterraneo

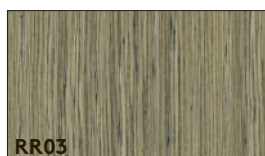

RR03

Rovere Argilla

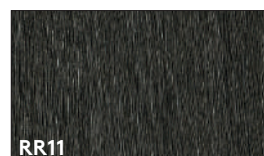

RR11

Rovere Fossile

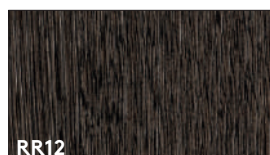

RR12

Rovere Dark



RR69

Rovere Corvino

ELM (OLMO)

has been appreciated since ancient times for its elegance and the stateliness of its appearance. It boasts timeless beauty, also courtesy of a natural, flamed grain that further enhances its aesthetic harmony. It's available in three versions in the Cesar palette: Sbiancato, Toscano and Grigio. Olmo finishes are supplied with a continuous vertical grain match.

(vertical grain)

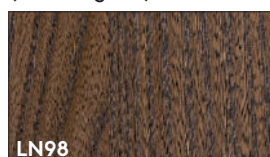

LN98

Olmo Toscano

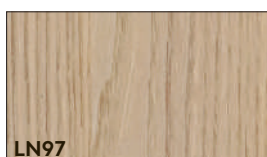

LN97

Olmo Sbiancato

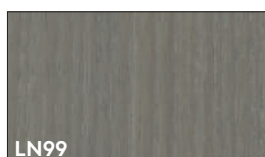

LN99

Olmo Grigio